

SCHONBEK®

CHANDELIER 3774- _____ TRIM DIAGRAM

(Finish Option) (Trim Option)

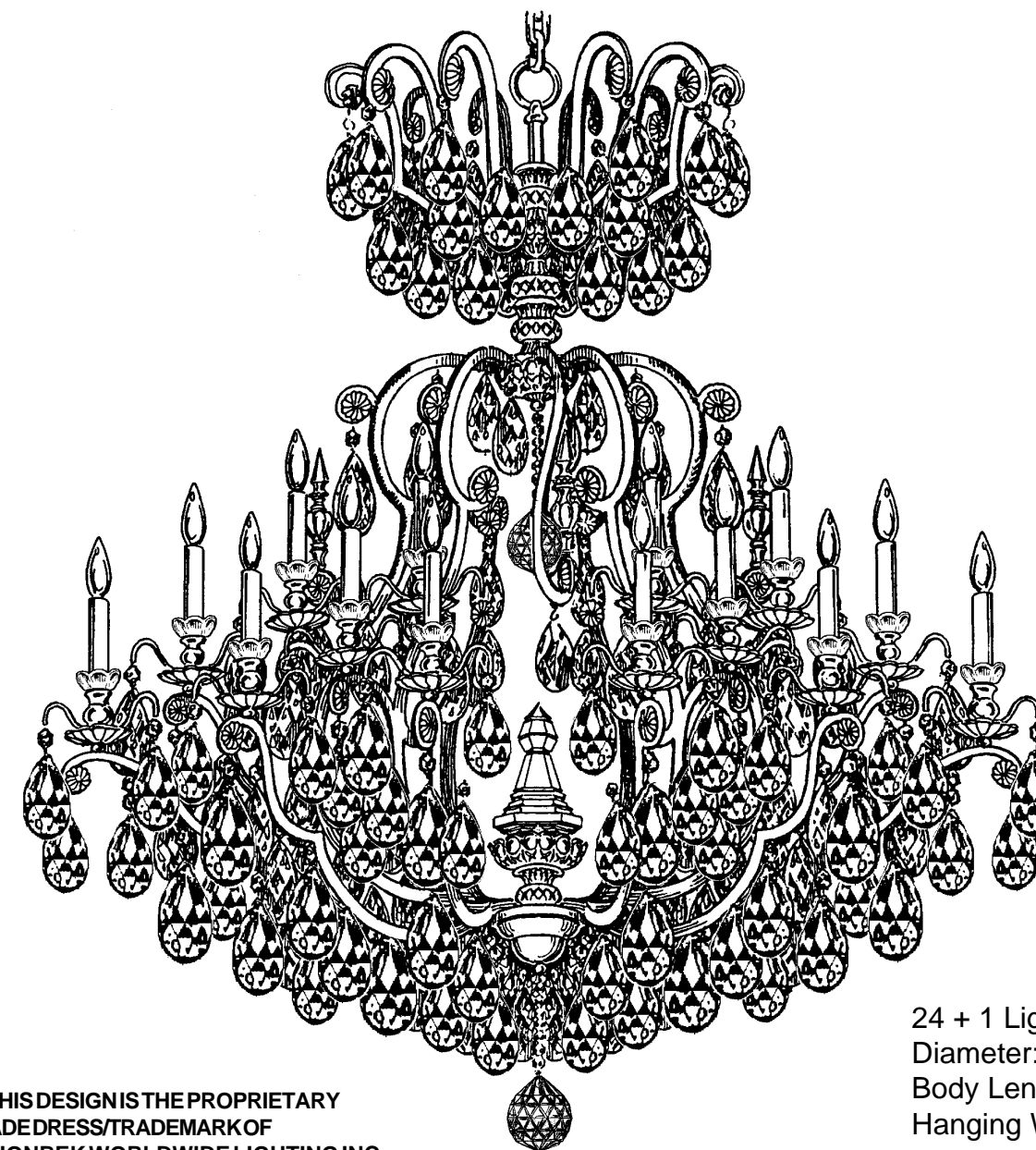

THIS DESIGN IS THE PROPRIETARY TRADE DRESS/TRADE MARK OF SCHONBEK WORLDWIDE LIGHTING INC.

24 + 1 Lights
Diameter: 45"
Body Length: 52"
Hanging Weight: 137 lbs.

SCHONBEK®

**Follow steps in exact order
Save this trim diagram for future reference**

1

IMPORTANT

Person who opens carton should record the following information for future service.

CODE # _____ Four-digit number on outside of carton.
PACKER # _____ See crystal package label.
ORDER # _____ See crystal package label.

SCHONBEK IS A WORLD LEADER IN CHANDELIER DESIGN. PATENTS INCLUDE:
#D5,222,805 & #D374,498

Instructions for electrician

STEPS 2 - 21

WARNING: THIS LUMINAIRE MUST BE MOUNTED OR SUPPORTED INDEPENDENTLY OF AN OUTLET BOX.

2 **WARNING:**

Electrical Danger Turn Power Off

All electrical components must be installed by a licensed electrician in accordance with the National Electric Code and the appropriate local electrical codes.

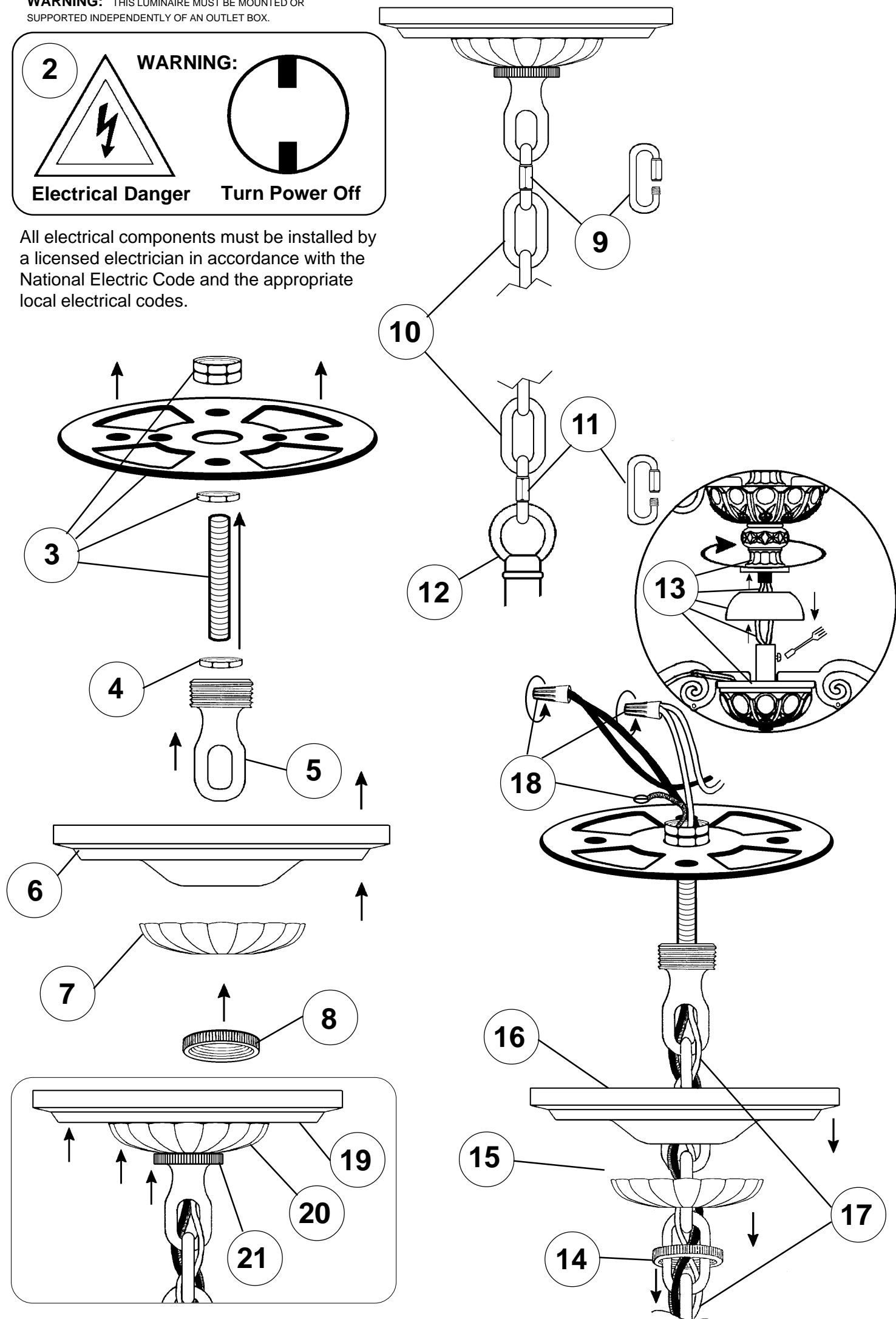

SET #1

N2793-**	N4003-**	N4015-**	N4018-**	N4020-**	N4007-**	N4002-**	N4040-**
2"	2-1/2"	2-1/2"	2-1/2"	3"	3-1/2"	3-1/2"	3-1/2"
50mm	63mm	63mm	63mm	76mm	89mm	89mm	89mm

SET #2

N4044-**	N4003-**	N4015-**	N4004-**	N4000-**	N4001-**	N4002-**	N4019-**
2"	2-1/2"	2-1/2"	3"	3"	3-1/2"	3-1/2"	3-1/2"
50mm	63mm	63mm	76mm	76mm	89mm	89mm	89mm

SET #3

N4003-**	N4015-**	N4018-**	N4010-**	N4020-**	N4007-**	N4019-**
2-1/2"	2-1/2"	2-1/2"	3"	3"	3-1/2"	3-1/2"
63mm	63mm	63mm	76mm	76mm	89mm	89mm

Crystal Set #3 in Black

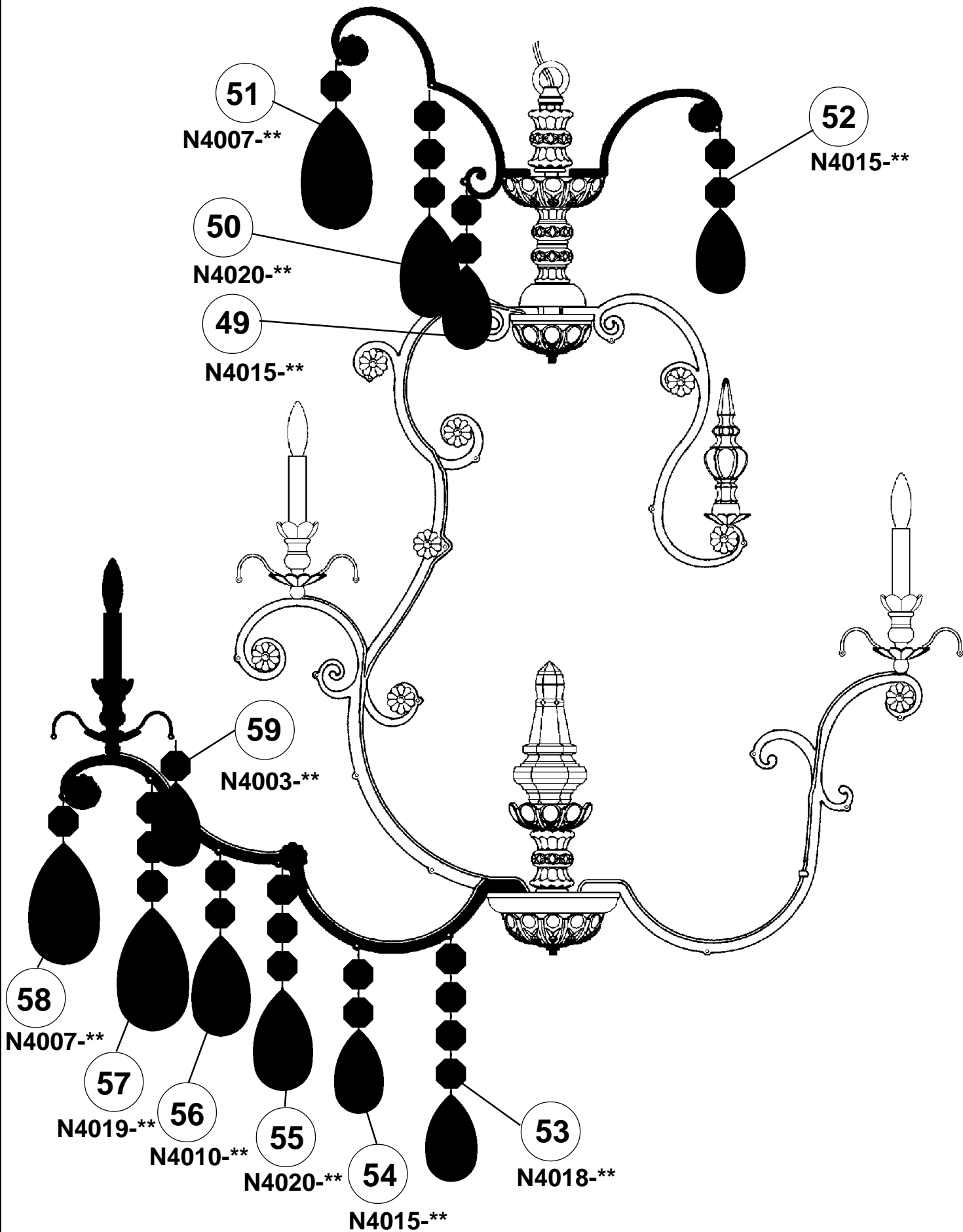

For easy removal of crystal from bubble pack, please cut along pouches on the inside of the seam. Gently remove crystal from the side of the pouch.

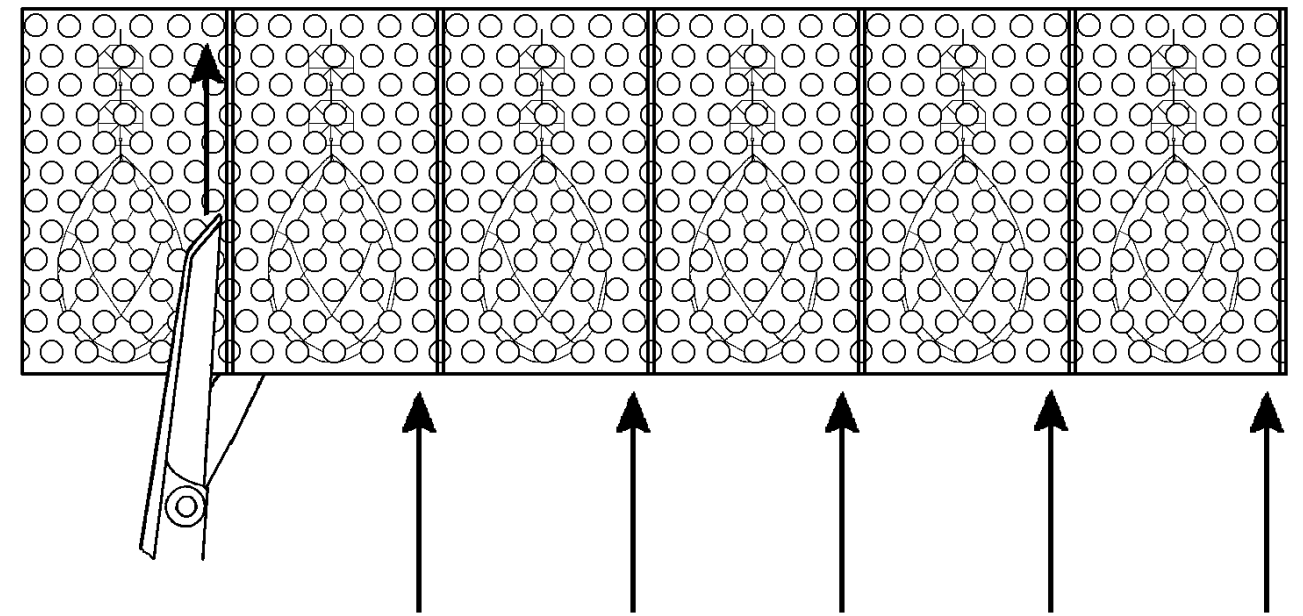

NOTE: Work on one crystal set at a time. Follow the black line from top to bottom according to the numbered steps on the trim diagram.

Instructions for crystal trimming
STEPS 22 - 59

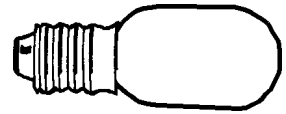

You will need 1 - T7
15 Watts Max
(Center Light)

23

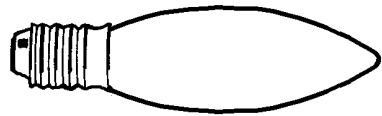

You will need 24 - C10
25 Watts Recommended
60 Watts Max

Install bulbs and be
sure to test fixture
BEFORE trimming.

FIXTURE INCLUDES:
Hanger Hardware
Trim - Frame
1 - T7 Light Bulb

DOES NOT INCLUDE:
C10 - Light Bulbs

27

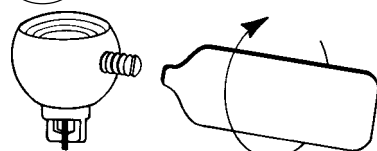

Tighten With
Tool Provided.

Crystal Set #1 in Black

28
N2793-**

32
N4007-**

30
N4015-**

22
#90002

39
N4003-**

38
N4002-**

37
N4040-**

36
N4020-**

35
N4018-**

26
N11124-**

29
N2793-**

24
#9552/180

31
N4003-**

33
N11125-**-**

25
#9551/150/1

34

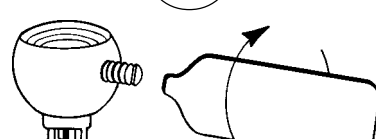

Tighten With
Tool Provided.

Crystal Set #2 in Black

#9418

#9319

#9419

#9419

#9302

#9302

#9418

#9319

40

N4044-**

41

N4044-**

43

N4001-**

48

N4003-**

47

N4019-**

42

N4000-**

45

N4002-**

46

N4004-**

44

N4015-**



**SPARE PARTS KIT
PROVIDED.**